

DAIRY FLAT NEWSLETTER

Produced by the Redvale Landfill Community Liaison Committee
and the Dairy Flat Community Trust

Publisher – Waste Management NZ Ltd
November 2017

Delivered by – Silverdale Pony club
Volume 26 Number 3

REDALE LANDFILL COMMUNITY LIAISON COMMITTEE

Current members:

Rob Leinwand ----- Chairman & Resident Liaison Officer
Nigel Donovan ----- AC
Louise Johnston-----AC
Bob Gibbs ----- Local Resident
Bill Earwaker ----- Local Resident
Kirk Storie ----- Local Resident
Richard Croker----- Local Resident
Stephen Walker ----- Local Resident
Jennie Hutchinson----- Local Resident
Nick DeWitt----- Local Resident
David Hardy ----- NHTCC
Debbie Marshall ----- DF Primary School Principal
Mark Drury ----- Peer Review Panel
Fiona McKenzie ----- Manuhiri Kaitiaki Charitable Trust
Chris Wills ----- Waste Management
Andy Vosper ----- Waste Management
Rob Bailey ----- Waste Management

The Committee's role is to allow issues and concerns relating to the operation of the landfill to be debated and negotiated. Should you have any questions or concerns regarding Redvale Landfill please contact Andy Vosper on 09 427 0600 or your nearest Liaison Committee member.

Members were elected to the Committee by the community or have been appointed to represent particular interest groups. **Minutes of the meetings are available for perusal at the Waste Management NZ Ltd office.** Any member of the public is able to attend and be heard at these meetings as long as at least two days' notice is given to the Secretary, Steph, via email - Redvale@wastemanagement.co.nz

Our next scheduled meeting at the Waste Management Office – March 12, June 11, Sept 10 & Dec 3 2018.

DAIRY FLAT COMMUNITY TRUST



Current Trustees:

Julie Earwaker *Steven Earwaker*
Graeme Stubbing *Treve Kunzli*
Susan Whineray *Andy Vosper*
Mark van Dam

The Dairy Flat Community Trust is a charitable Trust to administer and distribute monies provided for the

Community of Dairy Flat by Waste Management NZ Ltd.

Please see our Trust website:

www.dairyflatcommunitytrust.co.nz

Should you have any questions concerning the Trust, please contact:

Secretary – Steph Dryland - Ph: 427 0600

Community Liaison Chairman's Comment

November 2017

The Community Liaison Committee has experienced a quiet period since our last meeting held on 14 August.

Of note is the significant reduction in the number of complaints for odour or noise since August. The report tabled at the meeting on 13 November showed only 6 complaints total for the period, down from the 15 that were tabled at the August meeting. It is also noted that there were zero noise complaints during the 3-month period.

The CLC was advised that Waste Management has approved a CapEx (Capital Expense Approval) to purchase 2 new generators that will be added to the existing units, bringing the total to 14. Marshall Day, who are the noise consultants used by Waste Management, have been given a contract to investigate and recommend a method to keep noise within consent limits when the new generators are added. The generators will not be on line for several months due to the long lead time for manufacturing and shipping.

Waste Management also advised the committee they have been contracted to build a tyre shredding plant in the Wiri area. During the period the shredding plant is being built and commissioned, tyres will be stored at Redvale. The current plan is to then send the stored tyres to the shredding plant. We were told the tyres will not be visible from Horseshoebush Road, Tender Road or Richards Road and will not be an eyesore.

The committee questioned Waste Management regarding annual reporting as specified in their consent conditions. Waste Management agreed to review and generate the reports as specified in condition 63, 66 and 68 of their Resource Consent document.

This was the final meeting for 2017. I would like to wish the CLC members, Waste Management, and the Redvale/Dairy Flat communities the best for the festive season; travel safely and keep well in 2018.



Feeling Fab Charitable Trust

12 Aileron Rise
Dairy Flat
Auckland 0794
Phone: 0211373155
www.feelingfab.co.nz

I would like to introduce you to the Feeling Fab Charitable Trust established November 2016.

We are a non-profit organisation who provide pamper days for those who have experienced grief, caregivers and individuals who are in need through a variety of unfortunate circumstances.

Our aim is to provide a safe nurturing environment for women to experience a full day of pampering.

We are here to help them to leave the blanket of grief and their worries at the door. They will be pampered by our most caring and understanding volunteers. Starting with a massage/Reiki or healing and followed by a makeover and hair styling. There are also goodie bags for them to be able to take home and enjoy. Yummy food is provided throughout the day.

Our aim is to give back some of the love, support and tenderness that seems to disappear when we are faced with grief or overwhelmed by life. This is also a great opportunity to connect with others who are going through similar experiences, something which bereaved people generally find really helpful.

We have received fantastic feedback from the women who have attended and the volunteers who have given up their time freely to support them and make these days possible.

Please take a moment to have a look at the short video that is on our website at www.feelingfab.co.nz as this will give you an example of what our pamper days entail.

We are always looking for volunteers to help us on the days and any donations of goodies to put in the giveaway bags for our ladies.

*Kind Regards,
Elizabeth York,
Founder,
Feeling Fab Charitable Trust*

Greenpark Preschool

We have had a very busy term 3 at Greenpark Preschool. The spring term saw the children bringing their baby chicks, goats and lambs to share at mat time.

An interest in the kiwi led us to explore our native birds and insects. We started the term learning about kiwi. The children were interested in the nocturnal animals in our native bush and the topic soon extended to moreporks, kakapo, weta, giant snails, tuatara and lots more. The children also enjoyed learning about the moa. We made a huge life size cardboard moa which the children enjoyed painting. Sadly at 3.6m tall we hadn't got a wall big enough to display it! The children produced some amazing and detailed art work during this focus.

In August we held our annual Gumboot day. We invited our families to decorate their gumboots and join us for a fun day of gumboot dancing, gumboot racing and gumboot games. It was a great day with lots of parents and grandparents sharing the fun.

After seeing how much fun the children had in a hut we made in the playground, we decided to have a hut focus. We made huts of all shapes and sizes in all sorts of materials. The children helped to make many of the huts – including an igloo made of bubble wrap and the houses of the three little pigs which we used for acting out the story. This focus led to some great imaginative and co operative play.

With the wet spring we have spent more time indoors. The children have enjoyed working with the puppets. This has developed storytelling and retelling skills as the children narrate while their friends use the puppets to tell stories.

Now the warmer weather is here we are looking forward to more outdoor games and water play. The children are enjoying baking in the sandpit and mixing up potions to use in their imaginative play.

If you would like to know more about our programme check out our website:

www.greenpark.net.nz.

Become a confident speaker

Come along to laugh and learn at Dairy Flat Toastmasters. Increase your leadership skills and speaking ability with other progressive local people.

When: Alternate Tuesdays 7.30pm-8.45pm

Where: Dairy Flat Hall, Corner of Postman Road and Dairy Flat Highway

FREE: Come as a guest for your first time complimentary

Contact: Tina Richards 027 291 8027

Silverdale Squash Club

If anyone is new to the area we would love to see you at Silverdale Squash Club. It is a great venue to meet others while having some (socially acceptable!) fun at the same time. It doesn't matter if you have never played before – we can show you how. It also doesn't matter how old you are. Our members range from 5 to 75!

For juniors, we our kids' club night is on Wednesdays 5pm – 7pm. Come and try it out! We've got lots of keen juniors taking part. Also tuition is still being run by the club's coach – so if anyone under 16 is interested, email the club at tonyforde@hotmail.co.nz or see our Facebook page.

We have several Interclub squash teams of all abilities – men and women and several mixed Masters teams. Our next tournament is 8 – 10 December for B grade and below.

For those who want to get seriously fit and really improve their squash, we can offer coaching sessions throughout the week.

We are always looking for new members – new to the game or experienced. Come along to our friendly Club Night on Thursday evenings 7pm onwards and give it a go.

For more information, contact the club president Tony Forde at tonyforde@hotmail.co.nz

Community Learning Directory available.

A Community Learning Directory for the Hibiscus Coast and surrounding communities has been produced to make it easier for people to find out what learning opportunities are on offer in our area.

There are over 140 tutors offering around 180 courses. The section headings are: Art and Craft, Business and Finance, Computing, Food and Cooking, Fitness and Recreation, Music and Dance, Language and Travel, Personal Development as well as a large section for Children and Teens.

Copies are available in the Dairy Flat store, the Orewa and Whangaparaoa libraries and the Citizens Advice Bureau in Orewa.

You can also view the booklet by going to the website www.hbclearn.co.nz and clicking on the book cover.

If you are a tutor or know of someone who tutors who would like to be included in the Directory, complete the simple form under 'tutors' on the website.

This is a free service for tutors.

Plants for Places

The key to a successful garden is selecting plants that are adapted to the conditions or adapting the conditions to the plants selected. It's unusual for one type of condition to persist 12 months of the year, so time frames need to be recognized.

Wet, wet, wet, wasn't it just!

River banks are often quite free draining but can be subject to periods of flooding, so plants need to be well anchored and able to tolerate being submerged for short periods; flax, putaputaweta (*Carpodetus serratus*), kowhai, all good river bank plants. If your river is tidal then there will need to be some tolerance to salty water; *Olearia solandrii*, *O. virgata*, and toitoi (*Cortaderia* species, native not Pampas).

Swamps are usually areas that retain a higher moisture level for most, if not all the year, plants need to tolerate lower levels of oxygen round their roots. Really wet areas and you're into the rushes, reeds, grasses and native herbs, raupo if it's a big area and the vigorous nature of this plant won't develop into a problem. Take a look at natural swamps and you'll see manuka, flax, cabbage trees, kahikatea growing on small islands within them, making use of any natural hammocks that occur. A third type of wet is winter wet. If water is being concentrated due to human activities, it's often best to try to rectify the problem at the source. This can be due to run off from hard surfaces, no guttering, over flow from water tanks, etc. Ponds and water features come into their own here, as do gutters and drains. Environmentally speaking slowing water down before it enters natural water ways has the least impact. A series of ponds at different levels is one answer, with a dense sward of vegetation such as rushes or grasses being another.

If your soil gets wet and boggy in winter, baking hard in summer the over all soil structure needs to be improved. Lime or gypsum helps clay soils. Compost in large quantities is a must with raised gardens being helpful, it's important to avoid plants known to require free draining soils. Lace barks, *Pittosporum tenuifolium*, flax's of course, are pretty forgiving, but these are difficult conditions for plants depending on the extremes of wet and dry, so build up and mulch as much as possible.

It's nesting time; that means rats, mice, mustelids (stoats, ferrets, weasels), possum and yes cats are active both hunting and reproducing so keep up the trapping, baiting and where appropriate shooting. Keep the family cat in at night, the garage is good if nocturnal wandering around the house is a nuisance, this at least restricts their range. You may not be concerned at what your cat may or may not do after dark but should you expect your neighbour to put up with it too? Care with dogs is also important; be aware of ground nesting birds when you take your dog for a walk, especially on the beaches, they may not catch the seagulls, dotterels, etc. but they do disturb them and a number of these birds are endangered so need to be given a wide berth with preferably no disturbance at all, leads play a wonderful role in such situations.

At the end of the day if we want to retain our native species we all need to consider our actions and the impact we make as individuals as well as collectively.

For plants and advisory service you can contact me:

Lisa Clapperton at Waitoki Plants

lisa@waitokiplants.co.nz

Phone 09 420 5455

North Harbour Sports & Country Club

We have had a busy year at the club refurbishing and upgrading. So far we have painted inside the main club area, replaced the old furniture and gotten some funky modern lighting. We have many more exciting renovations planned for the near future.

Summer is finally starting to show itself and our pool has been upgraded and is ready for swimming. Our heated salt pool has been thermal coated, no more paint peeling and the surrounding edges turfed with tiger turf matting for extra comfort and safety. The pool is open for everyone to use during the opening hours of the Foal & Fallow, members have use of the pool 7 days a week. Non-members only pay \$5 per swimmer to the bar.

Our Annual Christmas Party is once again almost upon us, on **SUNDAY 3RD DECEMBER 1PM ONWARDS, EVERYONE** is welcome to come along. There will be **free swimming** for all, **free sausage sizzle, bouncy castle, Santa will be arriving at 3pm** and there will be a **lolly scramble**. We will have discounted memberships if you join up with us on the day of the Christmas party and all existing members will receive a complementary drink (on presentation of membership card). We will also be selling Raffle and Christmas hamper tickets on the day (\$2 per ticket or 3 for \$5). Grab the family and come down for a fun afternoon in the sun.

We are always looking for suggestions how we can make our community club better for all please email any suggestions to us at nhtcc@xtra.co.nz .

Silverdale Pony Club:

Our season is off to a great start with Rallys at our grounds in Green Rd on Tuesday evenings. We have 6 experienced instructors and are looking forward to representing our club in the many upcoming pony club events. The grounds have dried out well and we are ready to host our first event on Sunday 26th November.

SILVERDALE PONY CLUB FUNDAY
10AM, SUNDAY 26TH NOVEMBER
Spot prizes
Decorate your pony!
www.silverdaleponyclub.co.nz

Update from Louise Johnston: Rodney Local Board

In Dairy Flat we have an absolute hidden gem and that is the 154 Hectares of farm land owned by Council in Green Road. This land was purchased by the former Rodney Council for a park and sports grounds. The farm is right in middle of the future urban zone and one day will be an oasis from the surrounding urban sprawl. From the road side the paddocks look pretty standard for Dairy Flat but out the back of the farm it is rolling hills, established trees and the Rangitopuni Stream. You cannot see another house for miles and I do believe that given its size and natural beauty this has the potential to be the Cornwall Park of the North Shore. The below map outlines in red where the Council own farm land is located.

Currently this farm land does not have park status and Council need to vest this land as a reserve and adopt a reserve management plan (RMP). The RMP will outline the plan for the future park. I really do think this farm can be so much more than just sport fields but a great place to go for a run or ride your bike. For the next financial year, I am trying to secure funding for a RMP and also I am trying to establish access for local residents. I will keep you updated with the progress.

The other project that I am passionate about is the Greenways Plan for the Dairy Flat subdivision. A Greenways plan is a network of pathways for walking, cycling and horse riding. Initial stages of the planning for Dairy Flat have just started and I have had some great feedback from local residents about important connections. Once a draft Greenways Plan for Dairy Flat is completed it will go out for public consultation but special interest groups are very welcome to get involved from the start. Please contact me if you are keen to be involved in the initial stages of this project.

In the last Dairy Flat newsletter, I mentioned about how Auckland Transport (AT) are now able to lower speed limits on our rural roads. I really appreciated the number of residents whom contacted me about this. The Rodney Local Board are receiving an update from Auckland Transport next week about which roads they will review first. Given that Rodney have some of the worst road death and serious injury statistics in Auckland I am hoping that there are number of our unforgiving roads on the list.

Lastly, if you are not happy with the state of your road, it is really important that you lodge the problem with Auckland Transport (AT). AT are not proactive and it is up to locals to report the issues. I really do believe that locals are the experts of their own roads. The easiest way to complain is via the AT website <https://at.govt.nz/about-us/contact-us/report-a-problem/>

AT do have investigate all complaints. If you are not happy with how AT have dealt with your complaint, please let me know and I will follow it up with them directly.

Please let me know if you need any further information etc. via email or call me on my mobile. louise.johnston@aucklandcouncil.govt.nz or Mobile 021 729 739

Map of Green Road showing (in red) the Council owned future park land

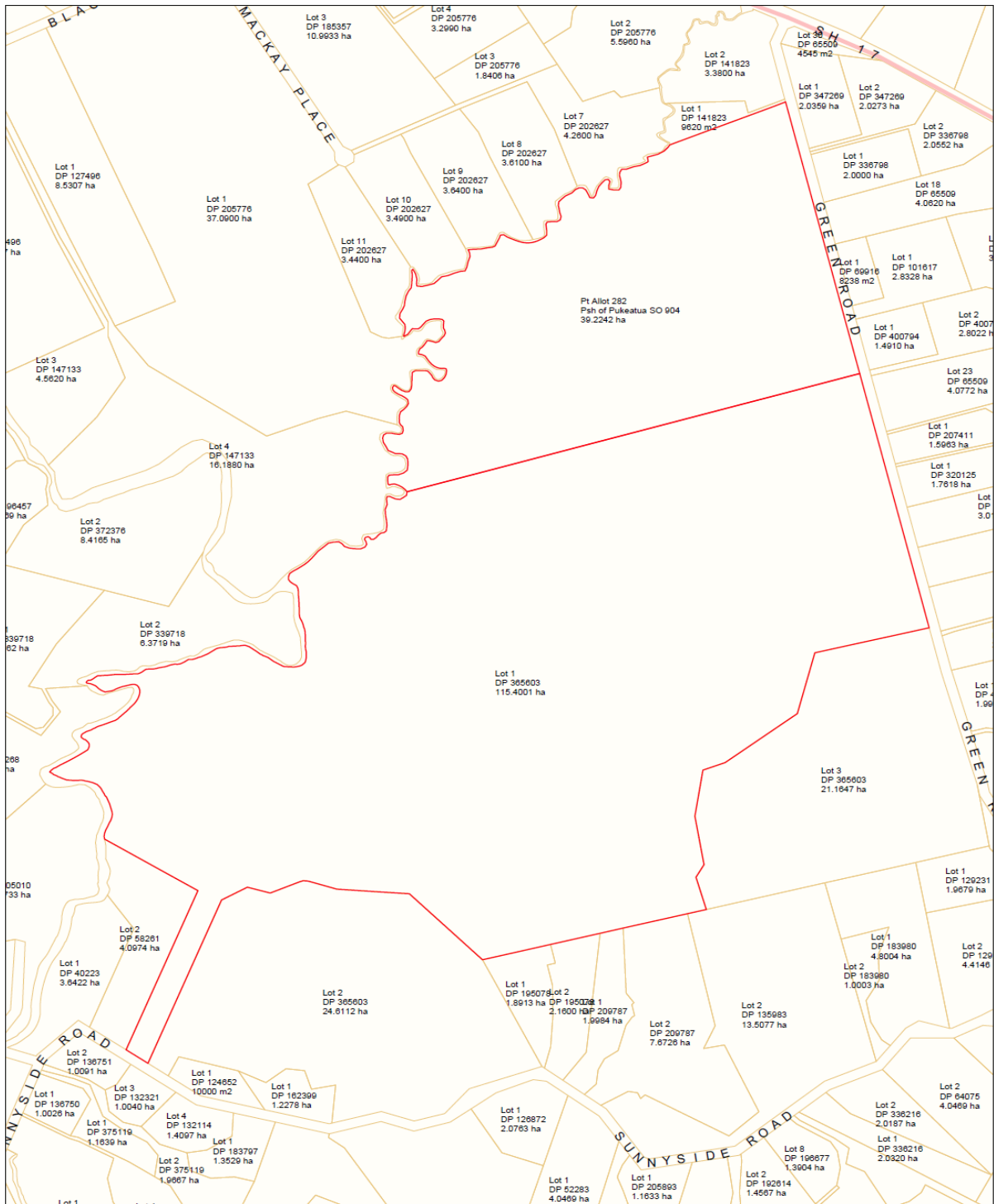

Head Office: 50 Centreway Road, Orewa
Private Bag 500, Orewa 1461, New Zealand
Tel: 0800 4265169, Fax: (06) 4267260
Email: info@rodney.govt.nz

**Pt Allot 282 Psh of Pukeatua SO904
Lot 1 DP 365603**

- Selected Parcels
- Parcel Boundary

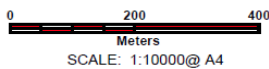

This plan is for information purposes only, and best produced in colour. Its content is NOT to be considered of survey grade, and should be verified prior to design or construction. While Council endeavours to provide accurate data, no guarantee as to the completeness and accuracy of the data shown can be given. Council accepts no liability for any error or omission whatsoever. Cadastral information derived from LINZ's LandOnLine database. Crown Copyright Reserved
DATE: 6 May 2010